

## 4 ZONE RGB+W STRIP RECEIVER



### RGBW LED



16 Millions of colors to choose



Dim brightness / Saturation / White mode



2.4G RF wireless transmission technology



Signal transmitting & Modes synchronization



Remote control  
Control distance 30m



Smartphone app control  
(2.4GHz gateway is needed)



Support third party voice control  
(2.4GHz gateway is needed)

### Connection diagram

FUT038 RGBW  
Connection diagram

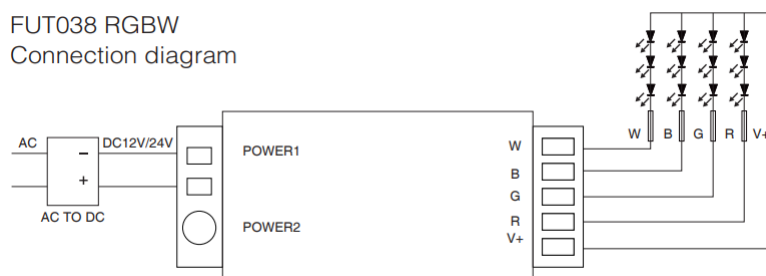

### Scan QR code to watch video instruction



Smartphone app control  
(WL-Box1 video)



Third party voice control

# Mode list

## M1. Fade in and fade out Here

different colors fade into each other

## M2. Strobe white

Just white color flashes up

## M3. RGBW fade in fade out

This program fades in and fades out the color red, green, blue and white one after another

## M4. Color flash

In this program, red, green, blue, white yellow purple flashes to change

## M5. Disco

Different colors strobe and flash to change

## M6. Red color ramp up and flash

In this program, red color brightens from 0%-100% and shuts down, then flashes three times

## M7. Green color ramp up and flash

In this program, green color brightens from 0%-100% and shuts down, then flashes three times

## M8. Blue color ramp up and flash

In this program, blue color brightens from 0%-100% and shuts down, then flashes three times

## M9. Color change+flash

Here several colors fade into each other and then flash randomly

**Note:** The colors can be dimming under any mode, the speed of any mode can be adjustable. For RGB LED strip light, the white is mixed from red, Green and blue, so the white is not pure.

## Compatible Remote

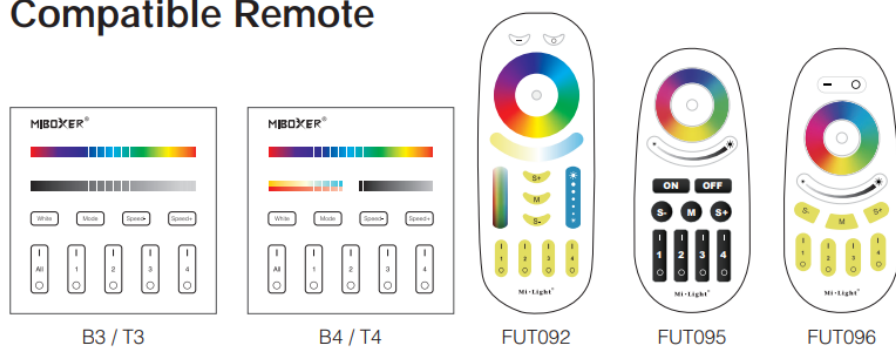

## NOTE:

Lighting can be working after linking with remote; for more details, pls read the remote instruction.

## Attention:

1. Please check whether the input voltage of the constant voltage power supply is in accordance with the controller, and please check the connection of both the cathode and anode, otherwise the controller will be broken.
2. Please don't connect wires with power on. Please switch on again only when it is in right connection and no short circuit.
3. Please do not use the controller in the place with widely range metal area or strong electromagnetic wave nearby, otherwise, the remote distance will be seriously affected.

\* The information in this datasheet may be changed by Everglow Lighting at any time without prior notice.

# 4-Zone RGB+CCT Remote

Model No.: FUT092

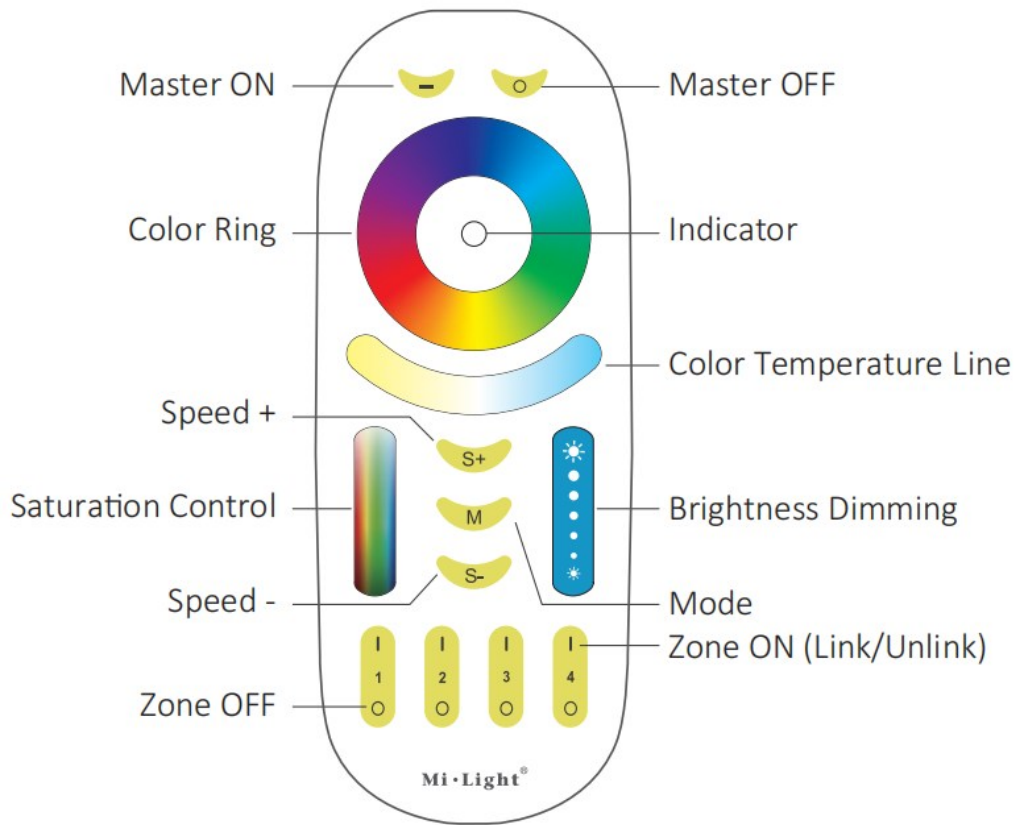

## 1. Features

Product adopt world-wide used 2.4GHz frequency, GFSK control method, with the features of low power consumption, long distance transmitting, strong anti-interference and fast communication rate. Adopt high-precision touching IC Touching is more stable and sensitive, can control specified Mi-Light / MiBoxer smart light with color, color temperature, saturation and brightness changing.

## 2. Products Key Diagram

1. Long press "Master OFF" or "Zone OFF" to night light mode.
2. Touch "Color Temperature Line" to white light mode and adjust color temperature.
3. Touch "Color Ring" to change the colors.
4. Press "Speed +" to accelerate the dynamic mode speed continuously until to fastest speed.
5. Press "Speed -" to lower the dynamic mode speed continuously until to lowest speed.

### 3. Linking Code / Unlinking Code Instructions

**Remark:** The light can be working after linking with the remote.

#### Linking Code Instructions

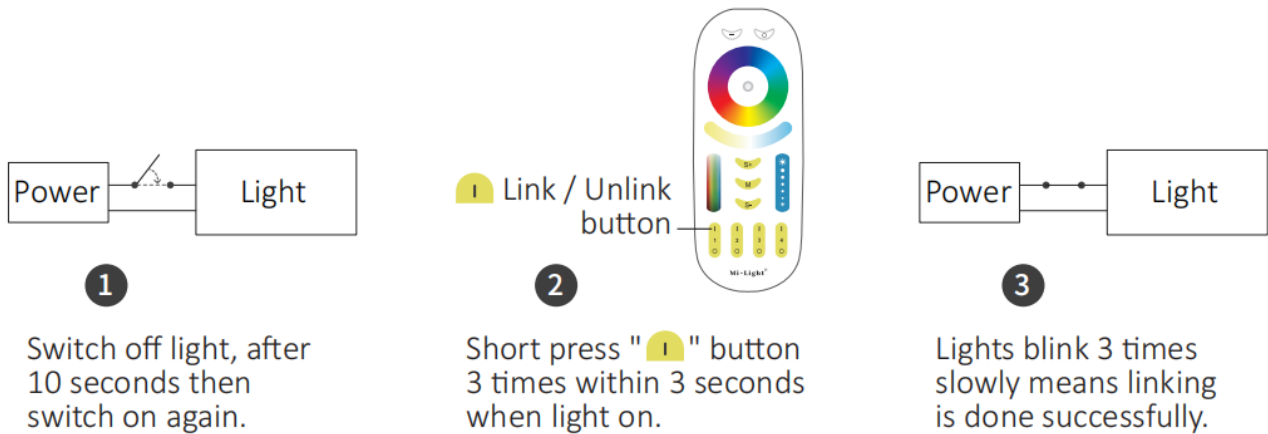

Linking failed if light is not blinking slowly, Please follow above steps again.  
(Note: Light that have linked can't link again)

#### Unlinking Code Instructions

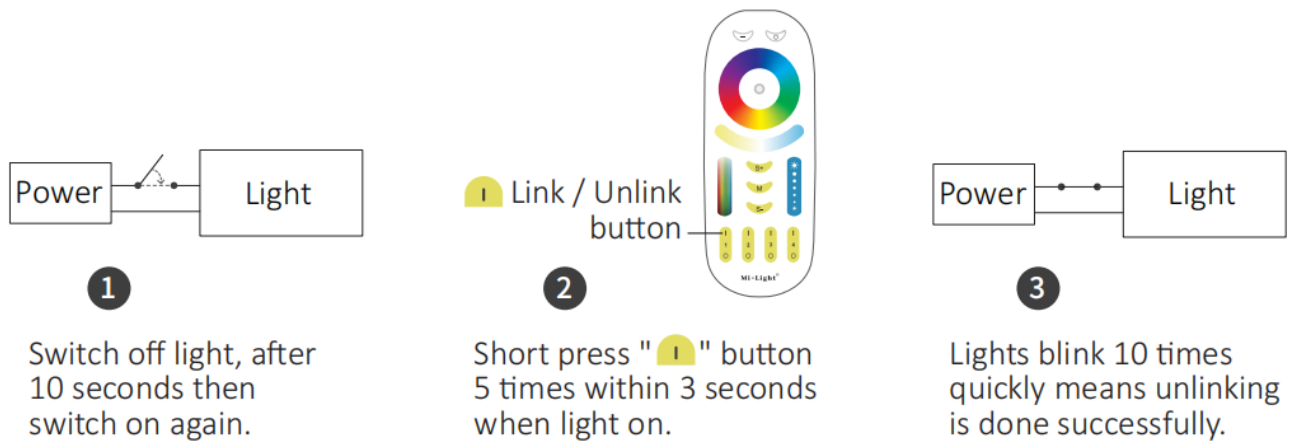

Unlinking must be the same zone with the Linking



Unlinking failed if light is not blinking quickly, Please follow above steps again.  
(Note: Light haven't linked that don't need to unlink)

## 4. Grouping of several lights

You can add an endless numbers of lights to a zone on the 4 channel remote by linking the lights to different zones. This way you are completely flexible in creating different group combinations. Below you can see some grouping examples.

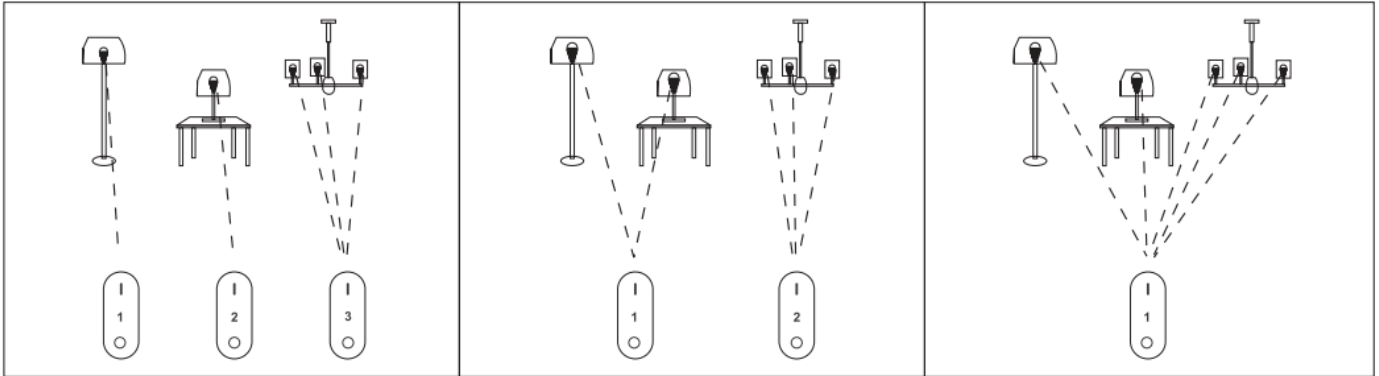

### Remark:

1. The user can re-programme freely as needed. One remote can control countless lamps or controllers, but one lamp or controller can only be controlled by four remotes (Max).
2. Please check the battery installation and controller (totally discharge the power), when you programme after switching off and switching on.

## 5. Attention

1. This remote only control specified Mi-Light / Miboxer products; not all Mi-Light / Miboxer series can work on this remote.
2. In the using of the remote, if the indicated lamp blinking quickly, Please change the battery in time. Please don't use poor quality battery to avoid the leaking of battery liquid to damage the remote.
3. This 2.4GHz remote is precise electronic product; don't use it in humid, high temperature, dust and high voltage environment; Saving it at indoor, dry and no static electricity environment.
4. Please don't use the remote on the wide-range metal or strong electromagnetic wave area, otherwise, it will badly affect the controlling distance.