

# 320Chips COB LED Strip Light

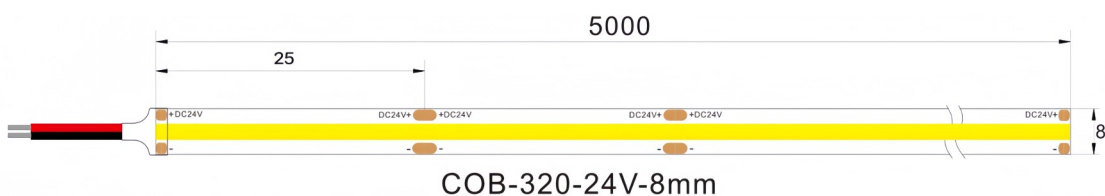

## Technical Specification

Model	SE-24V-8W-320-25-IP20		
Watts	8W		
Input Voltage	DC24V		
LED Chip	320 COB LED CHIPS		
Color Temp.	3000K	4000K	6000K
Lumens Output	720lm	800lm	800lm
CRI	Ra>90	Ra>100	RA>100
Beam Angle	180°		
Cutting Point	25mm		
Size	10000 * 08*1.2mm		
IP Grade	IP 20		
Operating Temp.	-20° - +45°		
Max Length	10M Per Driver		
Net Weight (kg)	0.26		
Certification	CE&ROHS		



\* The information in this datasheet may be changed by Everglow Lighting at any time without prior notice.

## 4 ZONE SINGLE COLOR STRIP CONTROLLER KIT

Product adopt the widely used 2.4GHz wireless technology with the features of low power consumption, long signal transmitting and strong



### Product Features

- Dim brightness
- Smartphone APP control (2.4GHz gateway is needed)
- 2.4GHz RF remote control Control distance 30m
- Support third party voice control (2.4GHz gateway is needed)

### Technical Parameters

Model No.: FUT036  
Output: Max. 6A/Channel  
Total output: Max. 10A  
Working Temp.: -20~60°C

Input voltage: DC12V-24V  
Output connection: Common anode  
Control distance: 30m

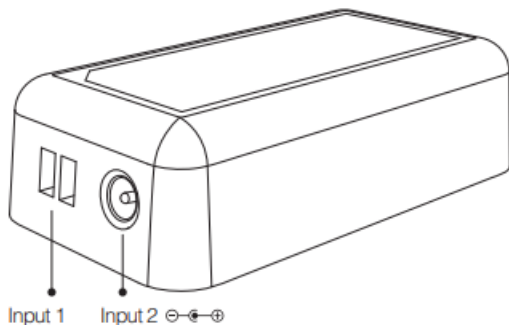

### Connection diagram

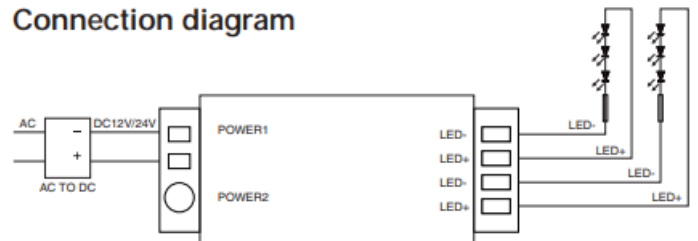

### Attention:

- Please check whether the input voltage of the constant voltage power supply is in accordance with the controller, and please check the connection of both the cathode and anode, otherwise the controller will be broken.
- Please don't connect wires with power on. Please switch on again only when it is in right connection and no short circuit.
- Please do not use the controller in the place with widely range metal area or strong electromagnetic wave nearby, otherwise, the remote distance will be seriously affected.

### Compatible Remote



Lighting can be working after linking with remote; for more details, pls read the remote instruction.



B1 / T1



B2 / T2



B4 / T4



FUT092

**Product Name: Color Temperature Remote Control  
(Full Button)**

Model No.: FUT007

Voltage: 3V(AAA \* 2PCS)

Transmission Frequency: 2.4GHz

Modulation Method: GFSK

Transmitting Power: 6dBm

Standby Power Consumption: 5uA

Control Distance: 30m

Size: 53\*21\*110.5mm

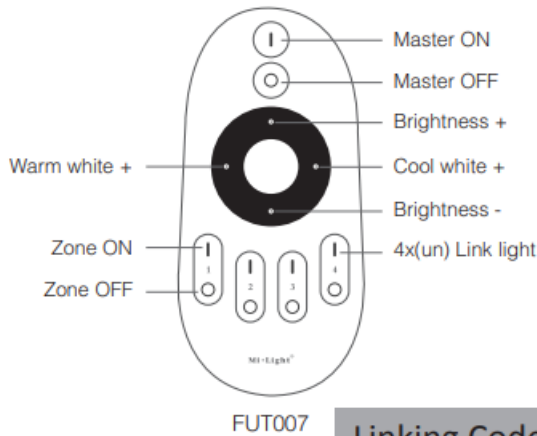
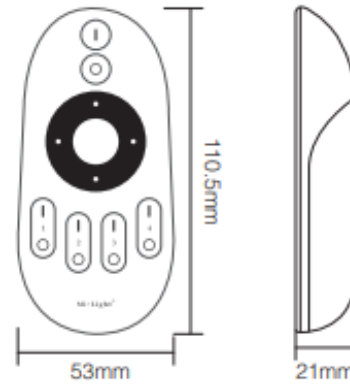

- To dim all dual white lights at once or change the color temperature, first press **'Master ON'**.
- To do this with individual lights, first press **'Zone ON'**. Second, set the adjustment for color temperature or brightness.
- To turn on the night light mode of a single ( dual white ) light, press and hold the **'Zone OFF'** from one of the 4 Zones.
- To turn on all the lights in night light mode, press and hold **'Master OFF'**.
- For remote control FUT006, the default mode is to adjust the brightness, rotating the wheel from left to right, brightness up, from right to left, brightness down. Switching to adjusting the color temperature by pressing the middle button once, left to right, cooler, right to left, warmer.

### Linking Code Instructions

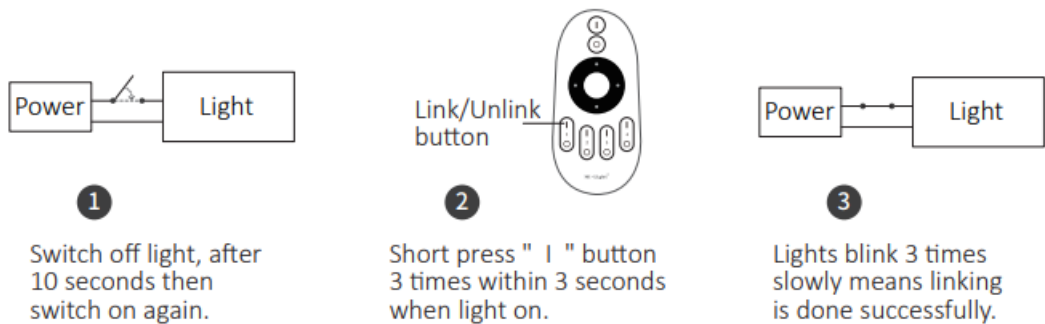

Linking failed if light is not blinking slowly, Please follow above steps again.  
(Note: Light that have linked can't link again)

### Unlinking Code Instructions

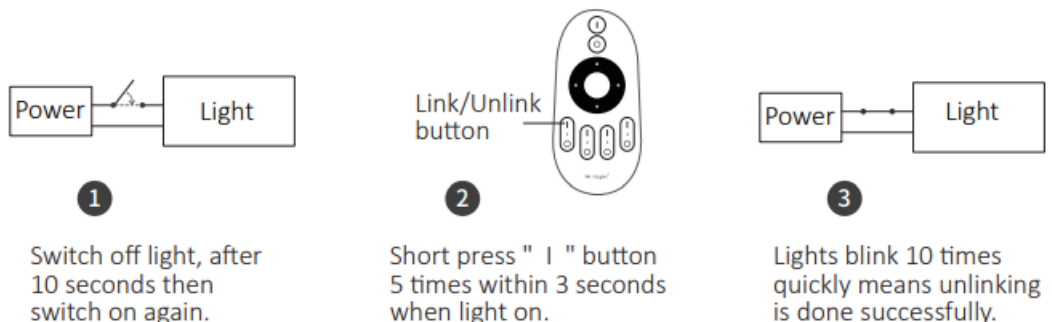

Unlinking failed if light is not blinking quickly, Please follow above steps again.  
(Note: Light haven't linked that don't need to unlink)



8mm

