

15W COB RGB LED Strip Light

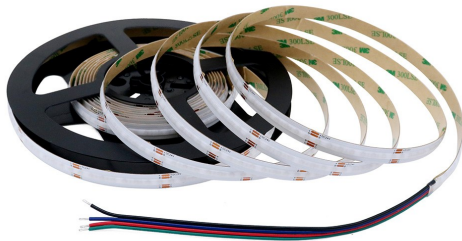

Technical Specification

Model	SE-24V-15W-RGB-IP20		
Watts	15W		
Input Voltage	DC24V		
LED Chip	480 Chips*COB LED		
Color Temp.	R	G	B
Lumens Output	625lm	525lm	470lm
CRI	Ra>80		
Beam Angle	120°		
Size	10000 * 10*1.2mm		
IP Grade	IP 20		
Operating Temp.	-20° - +45°		
Max Length	10M Per Driver		
Net Weight (kg)	0.166		
Certification	CE&ROHS		

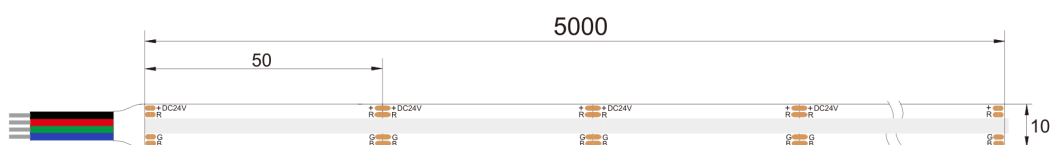



10mm



✓ 5MM 2P COB

✓ 8MM 2P COB

✓ 10MM 2P COB

✓ 10MM 3P COB

✓ 10MM 4P COB

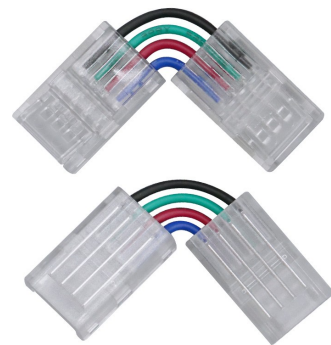

10mm 60°

4 ZONE RGB STRIP RECEIVER

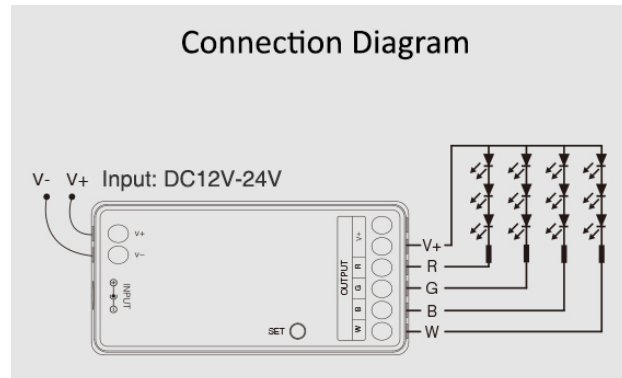

Support Tuya smart app control
(2.4GHz gateway is needed)

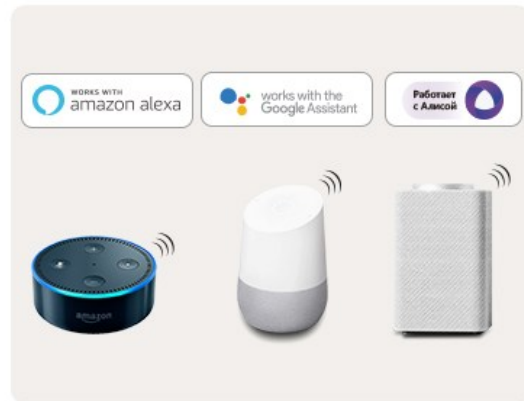

Support third party voice control
(2.4GHz gateway is needed)

Features

Product adopt the widely used 2.4GHz wireless technology. One remote control many controllers at the same time. Widely used on the controlling of hotel lighting and home lighting.

- 16 million colors adjustable, Saturation adjustable
- 4096 levels smooth dimming, Min brightness 0.1%
- One controller can be paired with 12 remote (Control distance 30m)
- Auto-forwarding: Automatically forward the remote control signal to another controller, making the remote control distance infinite
- Auto-synchronization: The same dynamic pattern is automatically synchronized to keep the pattern consistent
- Built-in 18 dynamic modes, including jump and gradient
- Support do not disturb mode setting, Suitable for areas with frequent power outages to save electricity
- Support PWM frequency switch To solve the abnormal noise problem of some power adapters
- Supports "Tuya Smart" app control (2.4GHz gateway is needed)
- Support Alexa, Google Assistant, Yandex Alice (2.4GHz gateway is needed)

Parameters

Name:	2.4G RGBW LED Controller	Input Signal:	2.4GHz RF
Model No.:	FUT038S	Control Distance:	30m
Input Voltage:	DC12-24V	Dimming Grayscale:	4096 Levels
Output:	6A/Channel	Dimming Curve:	0-100%
Total Output:	Max 12A	Dimming Curve:	Logarithmic
Output Power:	144W @ DC12V 288W @ DC24V	EMC Standard (EMC):	ETSI EN 301 489-1 V2.2.3 ETSI EN 301 489-3 V2.1.1
Output Type:	Constant Voltage	Safety Standard (LVD):	EN 61347-1:2015+A1:2021 EN 61347-2-11:2001+A1:2019
PWM Frequency:	Hight (4KHz) default Low (250Hz)	Radio Equipment (RED):	ETSI EN 300 440 V2.2.1
IP Rating:	IP20	Certification:	CE, EMC, RED
Working Temp.:	-10~40°C	Warranty:	5 Years

4-Zone RGB+CCT Remote

Model No.: FUT092

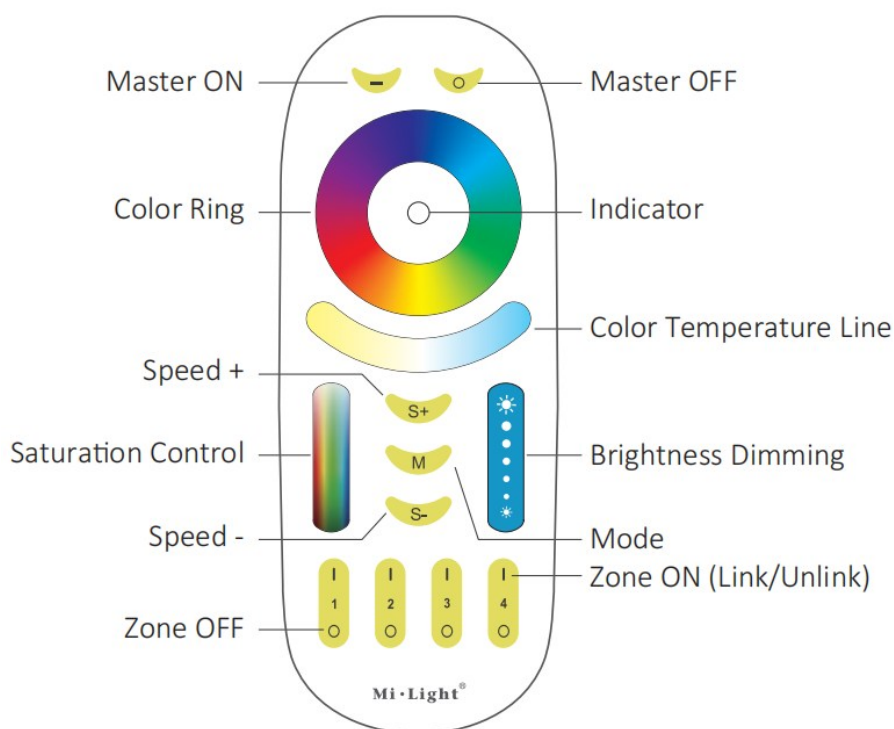

1. Features

Product adopt world-wide used 2.4GHz frequency, GFSK control method, with the features of low power consumption, long distance transmitting, strong anti-interference and fast communication rate. Adopt high-precision touching IC Touching is more stable and sensitive, can control specified Mi-Light / MiBoxer smart light with color, color temperature, saturation and brightness changing.

2. Products Key Diagram

1. Long press "Master OFF" or "Zone OFF" to night light mode.
2. Touch "Color Temperature Line" to white light mode and adjust color temperature.
3. Touch "Color Ring" to change the colors.
4. Press "Speed +" to accelerate the dynamic mode speed continuously until to fastest speed.
5. Press "Speed -" to lower the dynamic mode speed continuously until to lowest speed.

3. Linking Code / Unlinking Code Instructions

Remark: The light can be working after linking with the remote.

Linking Code Instructions

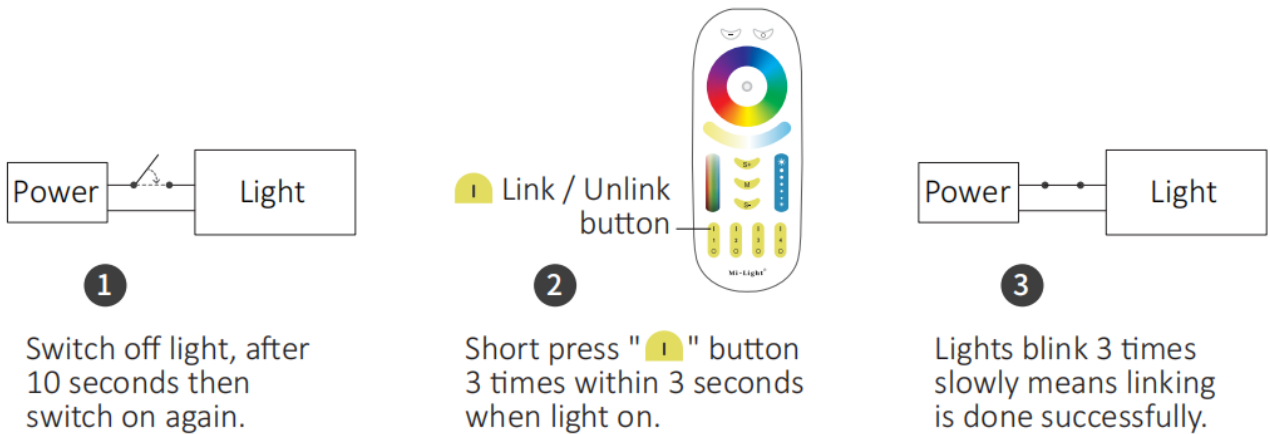

Linking failed if light is not blinking slowly, Please follow above steps again.
(Note: Light that have linked can't link again)

Unlinking Code Instructions

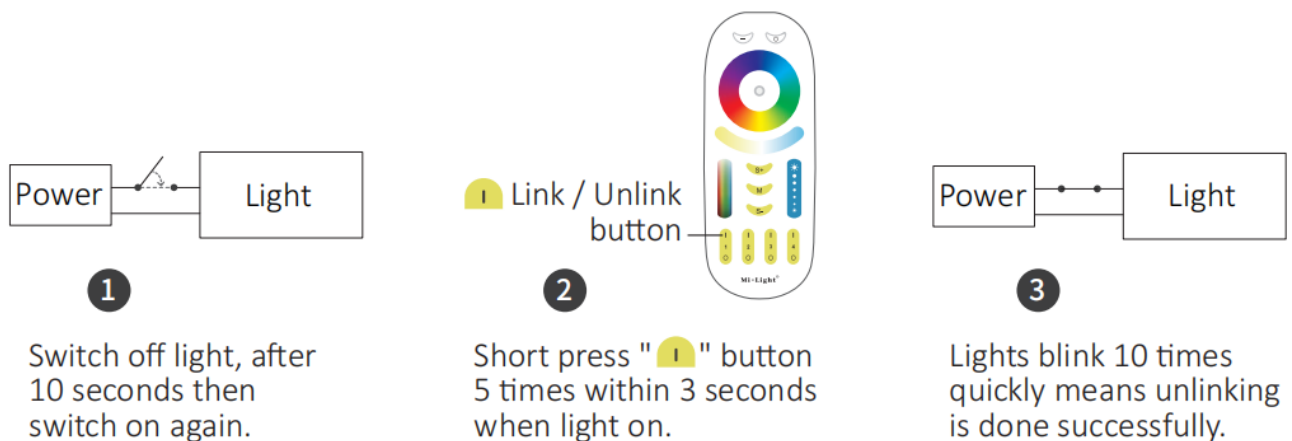

Unlinking must be the same zone with the Linking



Unlinking failed if light is not blinking quickly, Please follow above steps again.
(Note: Light haven't linked that don't need to unlink)

4. Grouping of several lights

You can add an endless numbers of lights to a zone on the 4 channel remote by linking the lights to different zones. This way you are completely flexible in creating different group combinations. Below you can see some grouping examples.

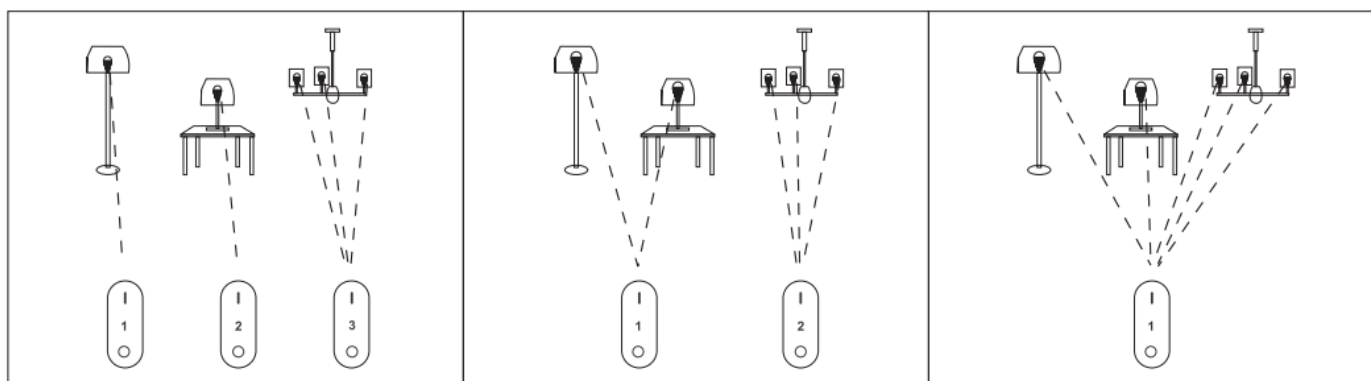

Remark:

1. The user can re-programme freely as needed. One remote can control countless lamps or controllers, but one lamp or controller can only be controlled by four remotes (Max).
2. Please check the battery installation and controller (totally discharge the power), when you programme after switching off and switching on.

5. Attention

1. This remote only control specified Mi-Light / Miboxer products; not all Mi-Light / Miboxer series can work on this remote.
2. In the using of the remote, if the indicated lamp blinking quickly, Please change the battery in time. Please don't use poor quality battery to avoid the leaking of battery liquid to damage the remote.
3. This 2.4GHz remote is precise electronic product; don't use it in humid, high temperature, dust and high voltage environment; Saving it at indoor, dry and no static electricity environment.
4. Please don't use the remote on the wide-range metal or strong electromagnetic wave area, otherwise, it will badly affect the controlling distance.



Technical Application

